

İLİ: TEKİRDAĞ

İLÇE: MALKARA

MAHALLE: ELMALI





ADA/PARSEL: 136 ADA 19, 20, 21, 22, 23, 24, 27, 28, 29, 30  
31, 33, 35, 36, 37, 38, 39 ve 40 NOLU PARSELLER

18.MADDE UYGULAMASI ADA BÖLÜM KROKİSİ

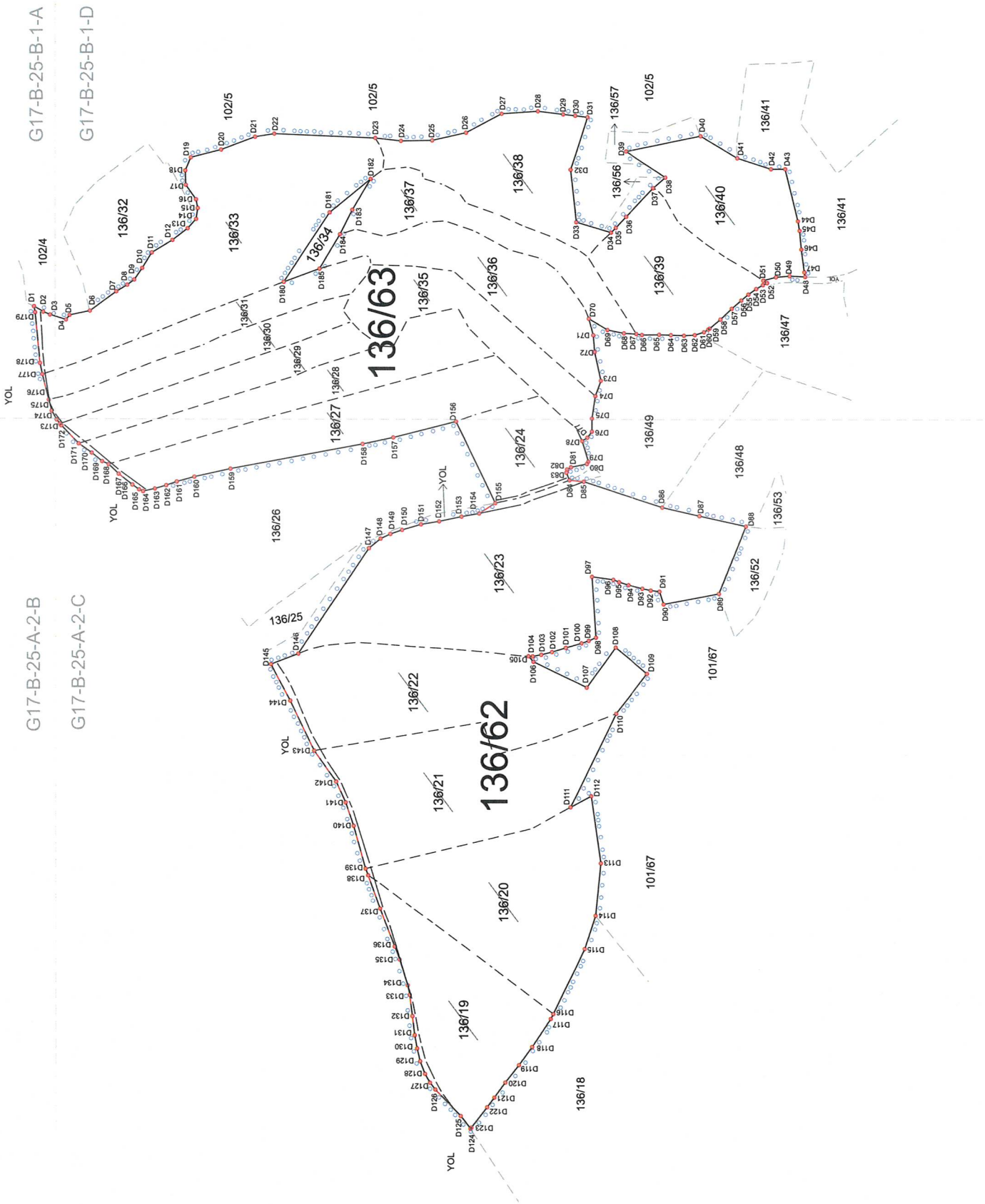

KROKİ



-  DÜZENLEME SINIRI
-  KADASTRO SINIRI
-  İMAR SINIRI (GÜNEŞ ENERJİ SANTRALI)
-  PLAN ONAMA SINIRI

ELLIPSOİD: GRS80

DATUM: ITRF-96

BAŞLANGIÇ EPOKU:2005.00

PROJEKSİYON: UTM (3)

DİLİM OR. M: 27

ADI SOYADI	UYGUNDUR BAKANLIK		UYGUNDUR KADASTRO MÜDÜRLÜĞÜ	
	DÜZENLEYEN	KONTROL EDEN	ONAYLAYAN	KONTROL EDEN
HEDEF HARİTA İNŞ. ENERJİ MÜH. SAN. VE TİC. LTD. ŞTİ. Harita ve Kadastro Mühendisi MEHMET MEFTAN DEMİR Hacı İlyas Mah. Müşşakbey Cad.No:22 Milas/Muğla Mühür V.D. No: 46113/096 - Qda Sicil No: 22032		Ayşe Nur SAHİN MOLDUR Harita Mühendisi		
İMZA				