

İL 4 895 779
ANKARA

İLÇESİ BALA-GÖLBAŞI

MAHALLESİ BAĞA BEYNAM MAHALLESİ
GÖLBAŞI, KARAALI ve HOLOS

NİTELİKLİ

BEYNAM ORMANLARI NİTELİKLİ DOĞAL KORUMA ALANI

(SÖNÜLEN) MAHALLELERİ

4 393 496

4 389 859

4 388 894

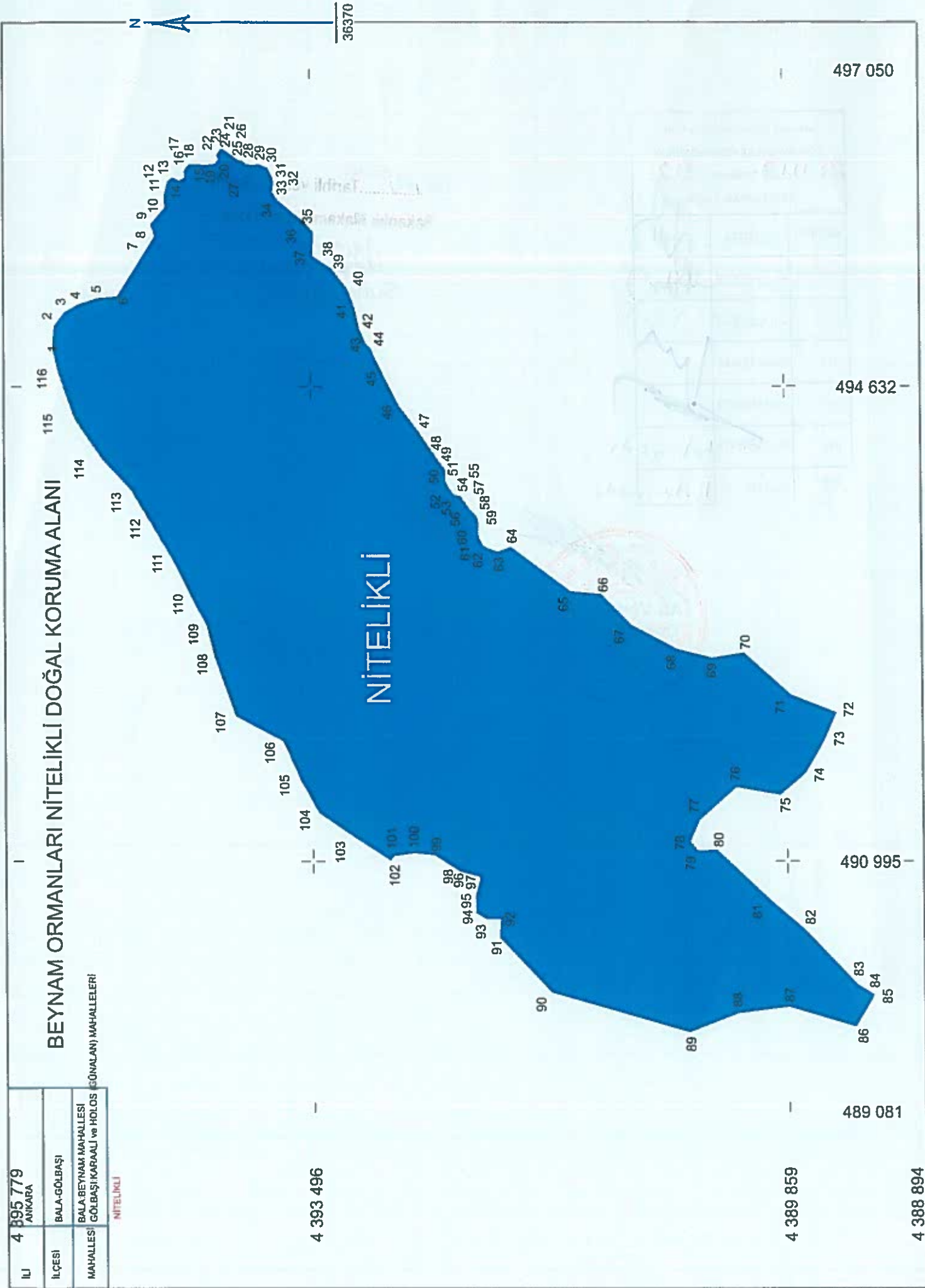

497 050

494 632

490 995

489 081

36370

İli	ANKARA				
İlçesi	BALA-GÖLBAŞI				
Doğal Sit Adı	BEYNAM ORMANLARI NİTELİKLİ DOĞAL KORUMA ALANI				
Koordinat Sistemi	ED50 3 DERECELİK KOORDİNATLAR (D.O.M=33)				
Alan (m2)	17005138.492				
Doğal Sit Adı	Hesap Alan	Nokta No	Y	X	Cephe
NİTELİKLİ	17005138.492	2	495095.92	4395458.55	132.89
		3	495199.92	4395375.82	110.86
		4	495253.75	4395278.90	159.34
		5	495304.36	4395127.81	152.81
		6	495318.74	4394975.68	443.61
		7	495694.73	4394740.25	97.43
		8	495777.50	4394688.86	94.27
		9	495866.63	4394719.55	168.99
		10	495994.62	4394609.20	83.68
		11	496078.04	4394615.89	117.80
		12	496193.17	4394590.97	49.33
		13	496222.77	4394551.51	57.16
		14	496198.36	4394499.82	50.48
		15	496223.03	4394455.78	49.22
		16	496272.01	4394460.71	29.15
		17	496298.08	4394447.67	41.63
		18	496326.62	4394417.37	132.73
		19	496316.56	4394285.03	64.01
		20	496328.01	4394222.05	45.58
		21	496363.12	4394192.99	33.76
		22	496393.04	4394208.64	55.37
		23	496439.18	4394178.05	24.44
		24	496433.82	4394154.20	135.34
		25	496354.18	4394044.77	30.79
		26	496348.78	4394014.46	41.72
		27	496321.72	4393982.71	53.36
		28	496316.15	4393929.64	45.72
		29	496323.46	4393884.50	72.08
		30	496294.19	4393818.64	73.64
		31	496228.32	4393785.70	47.50
		32	496181.90	4393775.64	73.43
		33	496109.24	4393786.28	69.81
		34	496052.45	4393745.68	279.28
		35	495873.53	4393531.24	92.02
		36	495803.47	4393471.57	177.80
		37	495625.97	4393481.76	110.89
		38	495565.55	4393388.77	66.46
		39	495529.14	4393333.18	199.39
		40	495372.18	4393210.22	155.29
		41	495226.46	4393156.54	169.95
		42	495060.58	4393119.60	117.76
		43	494953.82	4393069.90	46.09
		44	494922.17	4393036.41	231.76
		45	494712.03	4392938.67	268.12
		46	494474.57	4392814.18	226.11
		47	494293.92	4392678.18	281.57
		48	494061.89	4392518.67	82.38
		49	493996.60	4392468.44	32.65
		50	493964.14	4392464.91	63.01
		51	493901.16	4392463.04	98.83
		52	493816.24	4392412.48	29.86
		53	493796.51	4392390.07	41.85

Handwritten signature in blue ink.

Dođal Sit Adı	Hesap Alan	Nokta No	Y	X	Cephe
		54	493789.47	4392348.82	91.17
		55	493715.72	4392295.21	25.25
		56	493693.72	4392282.81	23.04
		57	493678.08	4392265.90	60.60
		58	493633.96	4392224.35	47.12
		59	493588.18	4392213.18	90.52
		60	493497.69	4392215.45	84.87
		61	493418.55	4392184.81	44.45
		62	493394.15	4392147.65	91.35
		63	493363.23	4392061.70	104.97
		64	493401.57	4391963.99	566.18
		65	493061.73	4391511.14	235.01
		66	493038.14	4391277.32	329.99
		67	492801.71	4391047.11	399.82
		68	492615.52	4390693.29	269.90
		69	492551.30	4390431.14	250.19
		70	492590.12	4390183.98	485.21
		71	492266.98	4389822.03	373.06
		72	492131.56	4389474.42	242.39
		73	491909.89	4389572.47	281.84
		74	491666.90	4389715.28	255.71
		75	491502.78	4389911.37	344.12
		76	491562.46	4390250.27	380.57
		77	491310.95	4390535.89	181.36
		78	491144.70	4390608.36	92.25
		79	491074.36	4390548.68	147.21
		80	491080.75	4390401.61	568.86
		81	490690.29	4389987.92	336.52
		82	490472.85	4389731.08	585.13
		83	490048.81	4389327.88	144.43
		84	489973.66	4389204.54	38.09
		85	489938.94	4389220.20	244.12
		86	489729.50	4389345.61	532.99
		87	489882.62	4389856.12	393.63
		88	489835.00	4390246.86	403.18
		89	489690.26	4390623.17	1093.08
		90	489992.91	4391673.51	573.98
		91	490411.89	4392065.83	144.36
		92	490555.97	4392056.76	118.38
		93	490556.56	4392175.14	83.86
		94	490600.58	4392246.52	145.74
		95	490746.32	4392245.33	123.87
		96	490865.29	4392210.83	24.29
		97	490882.22	4392228.25	141.21
		98	490918.00	4392364.85	234.74
		99	491044.04	4392562.88	159.23
		100	491058.97	4392721.41	151.59
		101	491038.00	4392871.54	46.38
		102	491003.01	4392901.99	318.65
		103	491176.13	4393169.52	339.63
		104	491368.22	4393449.60	283.64
		105	491617.50	4393584.93	323.50

[Handwritten signature]

Doğal Sit Adı	Hesap Alan	Nokta No	Y	X	Cephe
		106	491913.27	4393715.98	411.45
		107	492105.66	4394079.67	479.91
		108	492558.42	4394238.83	240.00
		109	492791.04	4394297.87	250.04
		110	493013.27	4394412.48	349.43
		111	493323.83	4394572.65	322.31
		112	493602.10	4394735.27	285.07
		113	493846.61	4394881.83	312.77
		114	494076.54	4395093.86	375.19
		115	494386.79	4395304.84	378.07
		116	494743.91	4395428.93	187.63
		1	494926.19	4395473.41	170.38