

İLİ	4 392 965 ANKARA
İLÇESİ	POLATLI
MAHALLESİ	MACUN MAHALLESİ

NİTELİKLİ

4 392 545

-

POLATLI İLÇESİ MACUN MAHALLESİ FOSİL ALANI NİTELİKLİ DOĞAL KORUMA ALANI

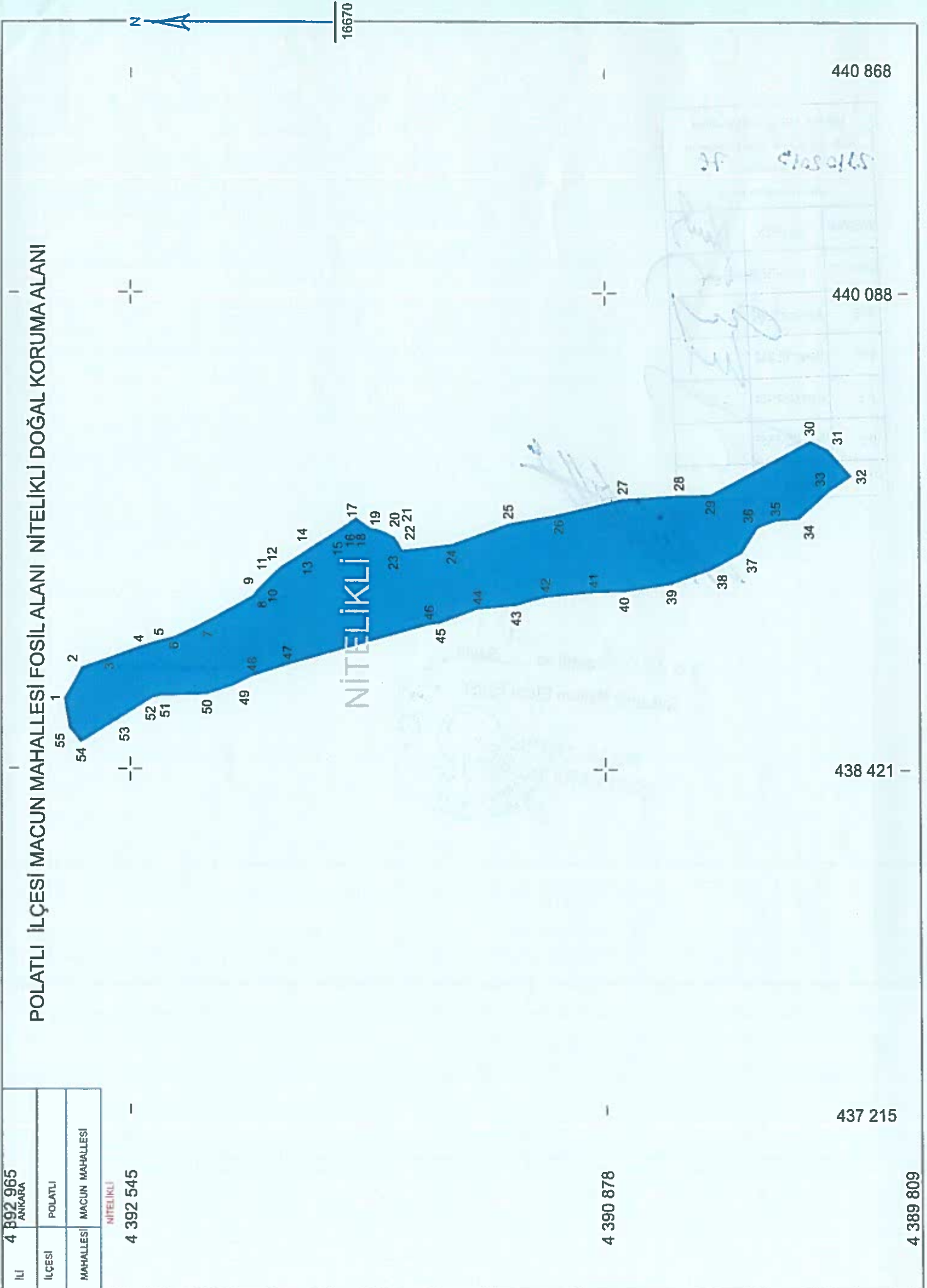

4 390 878

-

437 215

438 421 -

440 088 -

440 868

4 389 809

İli İlçesi Doğal Sit Adı Koordinat Sistemi Alan (m2)	ANKARA POLATLI MACUN MAHALLESİ FOSİL ALANI NİTELİKLİ DOĞAL KORUMA ALANI ED50 3 DERECELİK KOORDİNATLAR (D.O.M=33) 766425.778
--	---

1

Doğal Sit Alan Adı	Hesap Alan	Nokta No	Y	X	Cephe
NİTELİKLİ	766425.778	2	438775.83	4392713.12	99.74
		3	438808.77	4392618.97	109.47
		4	438847.41	4392516.55	73.66
		5	438869.22	4392446.19	52.79
		6	438882.03	4392394.98	96.16
		7	438922.28	4392307.66	218.28
		8	439026.31	4392115.76	29.44
		9	439049.28	4392097.34	27.46
		10	439068.09	4392077.34	40.15
		11	439097.19	4392049.67	48.43
		12	439129.68	4392013.76	69.16
		13	439166.03	4391954.92	55.70
		14	439197.08	4391908.68	71.44
		15	439235.05	4391848.16	52.13
		16	439263.33	4391804.37	66.01
		17	439300.81	4391750.03	61.74
		18	439264.31	4391700.23	24.32
		19	439260.08	4391676.28	26.66
		20	439251.87	4391650.92	41.55
		21	439232.07	4391614.39	30.33
		22	439206.57	4391597.96	21.61
		23	439187.72	4391587.42	171.47
		24	439208.50	4391417.21	211.60
		25	439280.64	4391218.29	179.51
		26	439314.03	4391041.91	232.15
		27	439367.85	4390816.08	198.77
		28	439381.46	4390617.78	109.80
		29	439383.90	4390508.01	400.17
		30	439573.76	4390155.75	70.18
		31	439543.03	4390092.66	124.57
		32	439450.22	4390009.57	93.89
		33	439397.57	4390087.31	145.62
		34	439298.55	4390194.07	83.31
		35	439292.74	4390277.18	67.82
		36	439268.76	4390340.62	105.31
		37	439179.30	4390396.18	117.92
		38	439123.38	4390500.00	153.60
		39	439070.05	4390644.04	167.64
		40	439043.59	4390809.58	108.45
		41	439040.88	4390917.99	171.05
		42	439023.34	4391088.14	107.06
		43	438993.62	4391190.99	134.63
		44	438981.24	4391325.06	141.40
		45	438931.70	4391457.50	38.35
		46	438927.07	4391495.57	515.21
		47	438785.82	4391991.03	133.47
		48	438744.84	4392118.06	68.57
		49	438714.04	4392179.32	103.33
		50	438681.10	4392277.26	158.65
		51	438676.45	4392435.84	29.04
		52	438670.13	4392464.19	159.63
		53	438585.05	4392599.26	137.57

g. s. m. d. an k  
b

Ada Parsel	Hesap Alan	Nokta No	Y	X	Cephe
		54	438512.13	4392715.92	63.99
		55	438561.26	4392756.92	107.08
		1	438667.02	4392773.72	124.56

A faint grid table is visible on the right side of the page. It has several rows and columns, with some handwritten entries in blue ink. The text is mostly illegible due to fading and overlap with other markings.